

# STOP



## FALL ARRESTER / SRL

The STOP is a durable fall arrest block (SRL 2-way) with a steel or synthetic cable. Engineered to remain in service for longer and conform to the latest ANSI/ASSP Z359.14-2021 and CSA Z259.2.2-17.



- Shock absorbing brake
- Stopping distance 0.6 m to 1 m
- Snaphook karabiner with fall indicator
- Steel or synthetic lifeline options
- Built to last
- Includes top karabiner

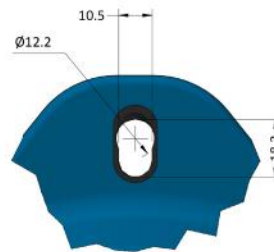

ANCHOR POINT DETAIL A



KARABINER DETAIL B

GSE514G / GSE510SSK / GSE514P  
Measurements in mm

Product Code	Conformity	Max. Working Load	Min. Working Load	Lifeline Length	Lifeline / Snap Hook Material
GSE510SSK	BS EN 360:2023 ANSI/ASSP Z359.14-2021 CSA Z259.2.2-17 AS-NZS 1891.3-2020	310 lb / 141 kg	132 lb / 60 kg	32 ft / 10 m	Stainless steel
GSE514G				46 ft / 14 m	Zinc plated steel
GSE514P					Synthetic lifeline, zinc plated steel snap hook
GSE525SSK				82 ft / 25 m	Stainless steel
GE530G				98 ft / 30 m	Zinc plated steel
GSE530P					Synthetic lifeline, zinc plated steel snap hook