

BATTERY ELECTRIC VEHICLE K5 SPECIFICATIONS



- For loads up to 500 kg.
- Short steering radius.
- Superelastic wheels for indoor use.
- Slow / fast speed adjustment.

👁 Front View



👁 Side View



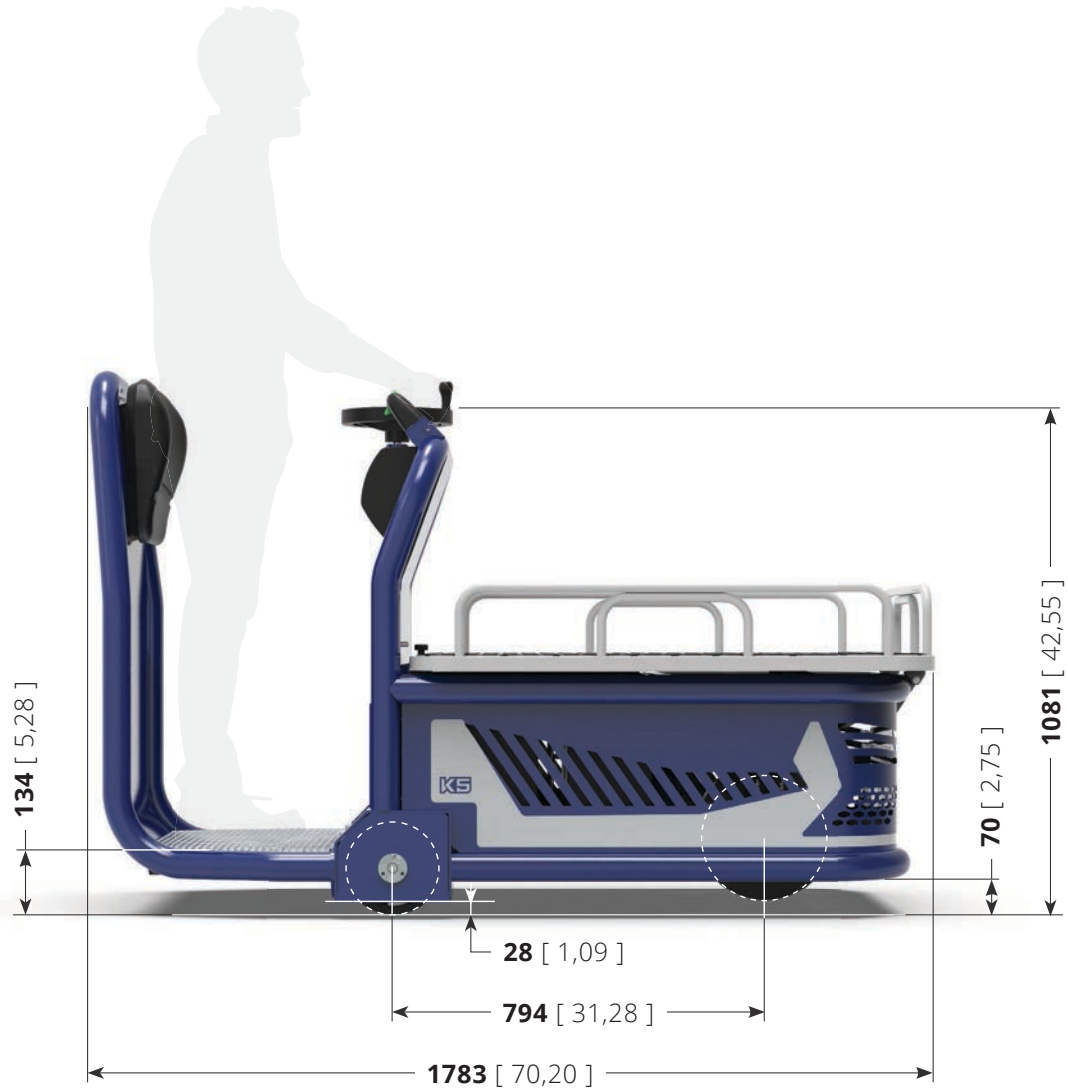

Zallys[®]

TABLE:

K5

Unit: mm [inch]

Main sectors



INDUSTRIAL
LOGISTICS

Performances on slopes

K5 can overcome slopes up to 5%, but the load it can carry may vary based on:

- **type of ground** on which the towing is performed;
- towing on **flat ground or on a slope**.

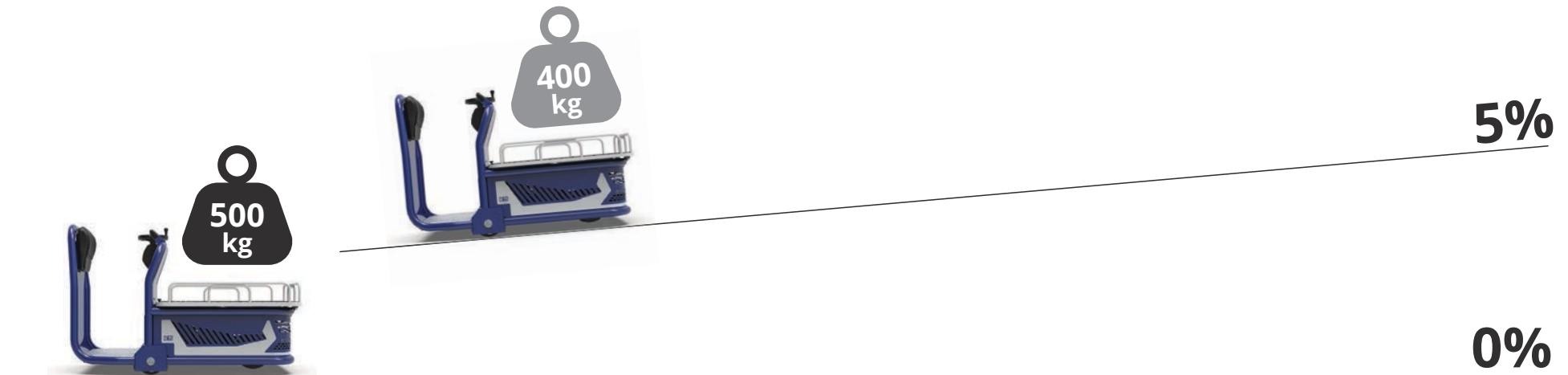

Ergonomic driving

K5's driving system with steering wheel has been studied to make the use of the machine more ergonomic and to guarantee great **comfort on a prolonged use** during the work shift. **All the driving controls are at your fingertips**, and on the LED display are always visible the battery charge level and the selected speed; the power key is on the right for an easy and fast ignition. **The structure** is made of **resistant materials** in case of accidental bumps.

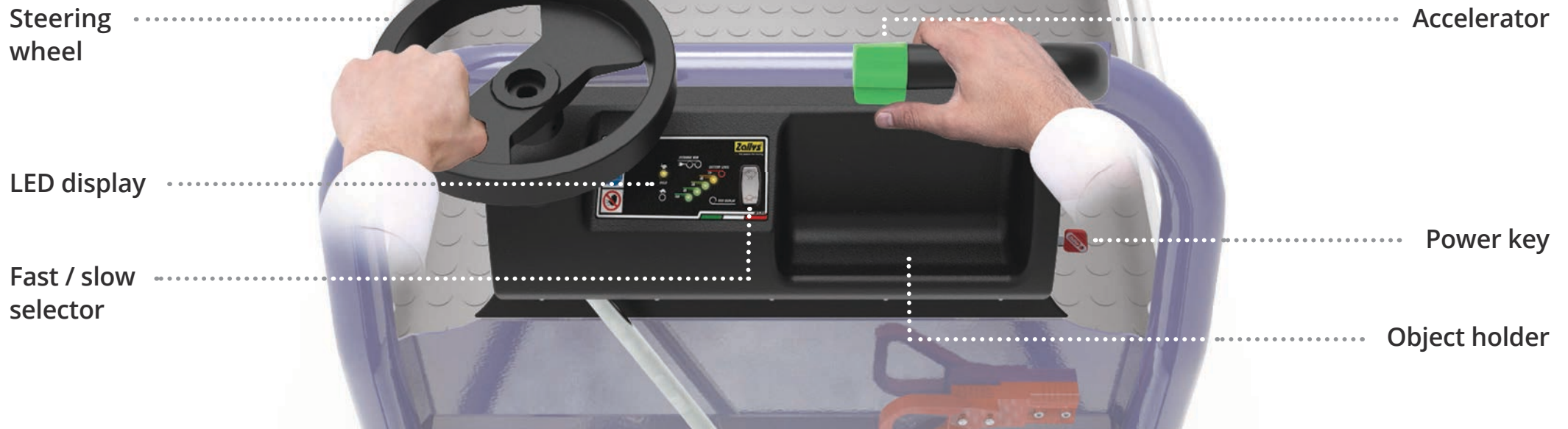

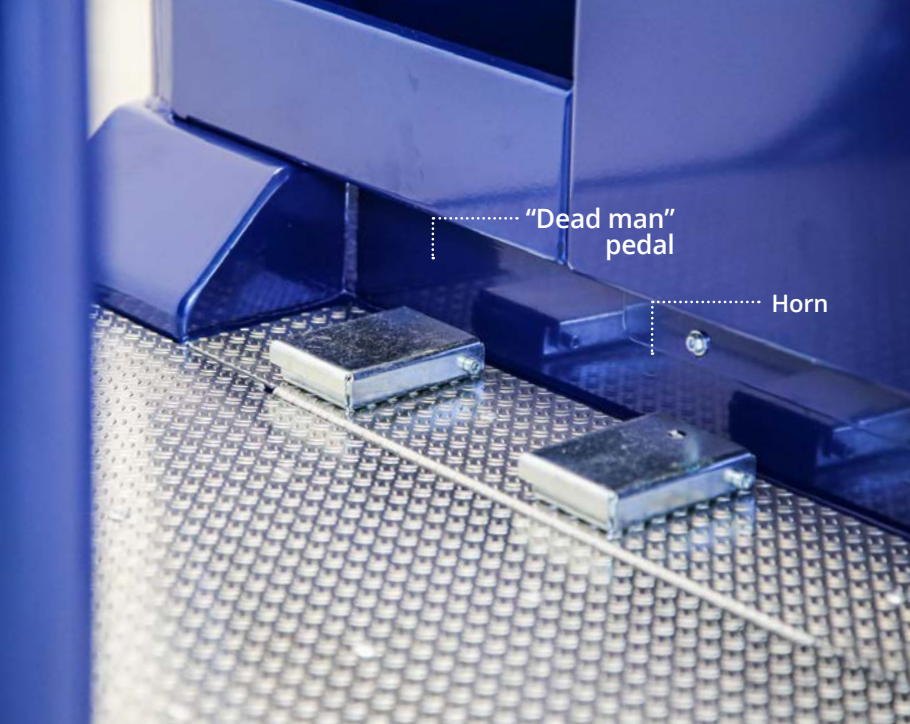

Maximum security

- On K5's footboard there are two pedals:
- **"dead man" pedal**, which guarantees the maximum security during the use of the machine: while it is not pressed, all drive controls are disabled, avoiding sudden and potentially harmful movements when the machine isn't in use;
 - **horn** to indicate the position.

Autonomy for a full working day

K5 is powered by four 300/350 Ah batteries, which guarantee the machine for **8 work hours operativity at continuous use**. Thanks to the high frequency external battery charger, batteries are easy to recharge.

