

Specifications

BINBLASTER

Bins inverted at ergonomic height for cleaning

Adjustable Type-C hitch to suit 80L-1100L wheelie bins

Extendable drip tray

Removable debris bucket

Galvanised steel construction

Control lever

Spray gun

Operation guide

Easy to move



Easy to recharge



Easy to use





1.0m

Tipping height



80kg

Lifting capacity



~20 standard bins per hour

Duty cycle

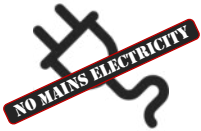

Water pressure or 12V battery

Power supply

BinBlaster is a smart bin wash frame with a power mechanism which lifts bins onto their sides one metre off the ground - the most ergonomic height for washdown. Also featuring an adjustable bin hitch, extendable drip tray, and removable debris bucket, BinBlaster saves you time, muscle and money.

Capable of lifting bins weighing up to 80kg, BinBlaster is available in both hydro and battery versions. The hydro model features an actuator powered by mains water pressure; a unique solution which eliminates shock hazards and allows operation in off-grid locations.

The battery model features an electric actuator and 12V/20Ah battery pack, which allows up to 40 bins to be cleaned per charge. When the battery is flat, it can be lifted out and recharged in a dry area using the supplied 10A charger, or swapped with a second battery for continuous operation.

Fitted with the standard Type-C hitch, BinBlaster can safely lift almost all EN840 wheelie bins from 80L to 1100L; hitches are also available to suit ANSI rollout carts and bulk bins. With a galvanised steel frame and simple design, the machine requires little maintenance, and can be used indoors or out. It is backed by a two-year warranty.



Specifications

BINBLASTER

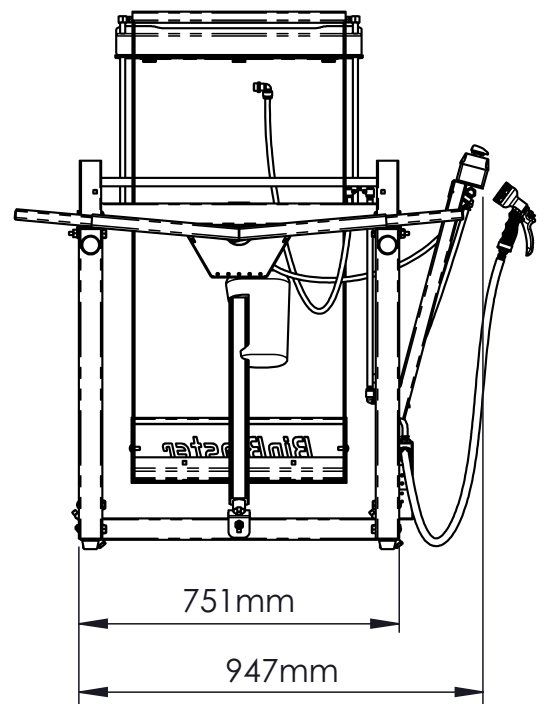
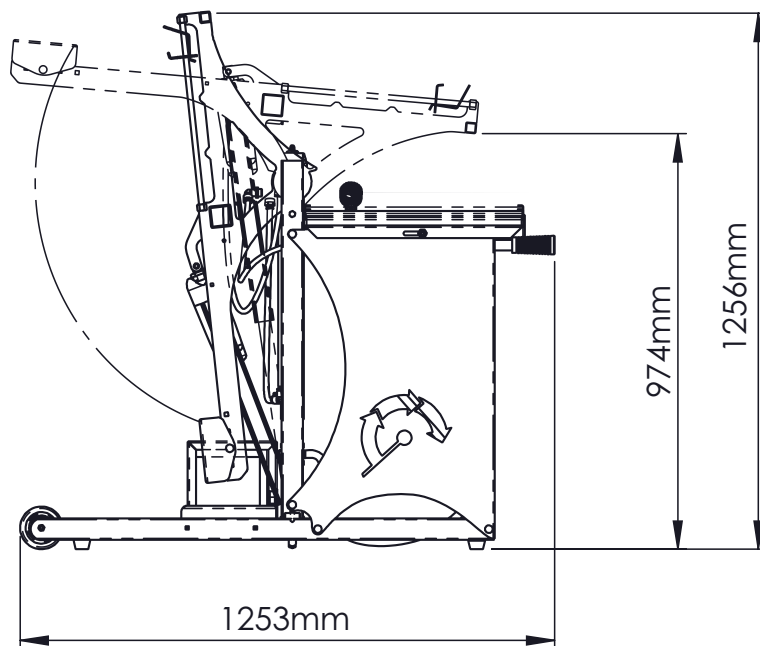
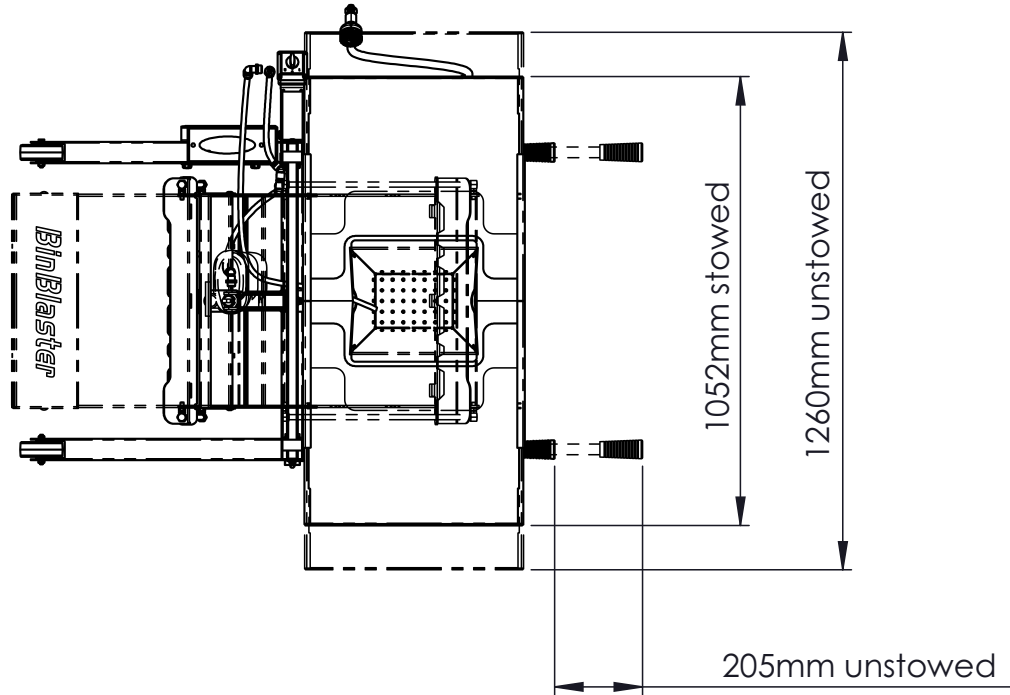

Layout and Dimensions

Specification Table

Key Parameters	1.1			
	1.2	Model	BB1000-B	BB1000-H
	1.3	Power Source	Battery	Hydraulic Pressure
	1.4	Role	Bin Wash Frame	Bin Wash Frame
	1.5	Tipping height	1000mm	1000mm
	1.6	Load capacity	80kg	80kg
	1.7.1	Cradle type	Type-C	Type-C
	1.7.2	Cradle mechanism	Comb-lift	Comb-lift
	1.7.3	Cradle standard	EN840	EN840
	1.7.4	Cradle compatibility	80L/120L/240L/660L/770L/1100L wheelie bins	
Weight	2.1	Weight	~78kg	~72kg
	2.2	Wheel Loading laden, front/rear	~44/35kg	~42/34kg
	2.3	Wheel Loading unladen, front/rear	~22/18kg	~20/16kg
Wheels	3.1	Tyre type	Resilex	Resilex
	3.2	Tyre size front	-	-
	3.3	Tyre size rear	□100x35mm	□100x35mm
	3.5	Wheel number, front/rear	-/2	-/2
Dimensions	4.2	Height overall	1256mm	1256mm
	4.3	Height drip tray	730mm	730mm
	4.5	Height cradle raised	1200mm	1200mm
	4.19	Length overall	1253mm	1253mm
	4.21.1	Width overall	1052mm	1052mm
	4.21.2	Width drip tray extended	1260mm	1260mm
Performance	5.2	Lifting speed laden/unladen	~0.12/0.16ms	~0.12/0.16ms
	5.3	Lowering speed laden/unladen	~0.16/0.16ms	~0.12/0.08ms
	5.4	Hydraulic flow rate max, lifting/lowering	-	~21.0/15.8lpm
	5.5	Hydraulic pressure max	-	~480kPa
	5.6	Operating cycle duration	~14s	~18s
	5.7	Throughput per hour/charge (no. bins)	~20/40	~20/-
	5.8	Operating gradient max	12%	12%
	5.1	Brake type	Surface friction	Surface friction
Powerpack	6.1.1	Powerpack type	Electric	Hydraulic
	6.1.2	Powerpack power source	12V Battery	~400kPa Water Pressure
	6.2.1	Actuator type	Electric linear	Hydro linear
	6.2.2	Actuator power	0.125kW	0.1kW
	6.2.3	Actuator force	<2500N	<2000N
	6.2.4	Actuator speed	0.05m/s	0.05m/s
	6.2.5	Actuator current draw	25A	-
	6.2.6	Actuator stroke	350mm	425mm
	6.4.1	Battery type	VRLA GEL	-
	6.4.2	Battery voltage/capacity	12V/20Ah	-
	6.4.3	Battery weight	6.5kg	-
	6.5.1	Battery charger type	Float charger	-
	6.5.2	Battery charger power	136W	-
	6.5.3	Battery charger output	13.6VDC 10A	-
	6.5.4	Battery charger input	85-264VAC 50/60Hz 1-ph 2A	-
	6.5.5	Battery charger charge duration	~3 hours	-
	6.7.1	Hydraulic ram type	-	Single-acting
	6.7.2	Hydraulic ram bore	-	80mm
	6.7.3	Hydraulic ram stroke	-	425mm
	6.7.4	Hydraulic ram displacement	-	2136cc
Other	8.1	Movement type	Pedestrian	Pedestrian
	10.7	Sound pressure at operator's ear	<40db(A)	<40db(A)